

Welcome

For your next corporate meeting or retreat, go beyond the four walls of the standard hotel location and discover the Westlake Village Inn. The luxurious and botanical property is nestled in the hills of Southern California, halfway between Los Angeles and Santa Barbara. Some of the amenities we offer include:

- ◆ 12,000 sf of event space with breathtaking vineyard, golf course and lake views
- ◆ Customized meeting packages tailored to remain within your budgetary guidelines
- ◆ 141 beautifully appointed guest rooms and suites which include wi-fi, flat screen TVs, Bose radios and continental breakfast served M-F.
- ◆ Mediterraneo, a chic stylish restaurant featuring seasonal ingredients which are prepared simply, the Mediterraneo way.
- ◆ Newest addition, The Stonehaus, an enoteca: fresh gourmet coffee, grab-n-go lunches and over 150 wines to sample or purchase



PROVENCE ROOM



VINTAGE ROOM



TASTING ROOM



WINE CELLAR



FAIRWAY ROOM



LAKESIDE ROOM



EXECUTIVE BOARDROOM

WESTLAKE VILLAGE
Inn



Westlake Village Inn Meeting and banquet facilities

Provence Room (2860 sf)

U-shape	35
Conference	40
Crescent rounds	100
Classroom	150
Banquet w/ dance area	200
Banquet	230
Theater	250

This is a split 2 level room with cast iron chandeliers, wood floors and an outdoor patio - located in the Provence building

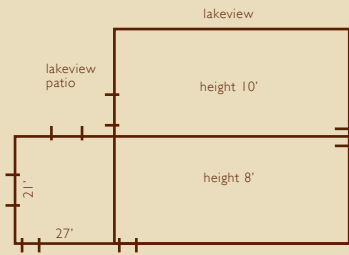

Lakeside Room (2800 sf)

U-shape	45
Conference	40
Crescent rounds	70
Classroom	75
Banquet w/ dance area	130
Banquet	140
Theater	200

The Lakeside patio adjacent to the room is perfect for dining - located in the Provence Building

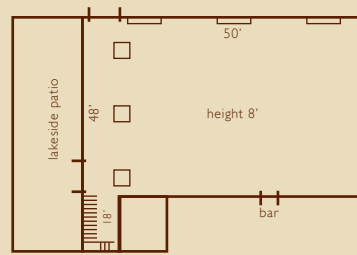

Fairway Room (2200 sf)

U-shape	30
Conference	40
Crescent rounds	56
Classroom	60
Banquet w/ dance area	100
Banquet	120
Theater	120

This room has floor to ceiling windows overlooking the lake and golf course - located in the Provence building

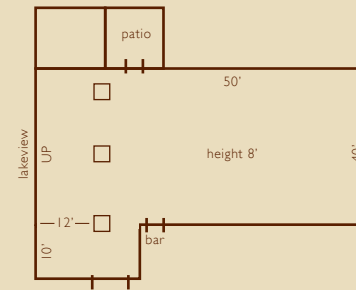

Wine Cellar (1486 sf)

U-shape	25
Conference	30
Crescent rounds	42
Classroom	40
Banquet w/ dance area	50
Banquet	60
Theater	60

The Wine Cellar is adjacent to the lake and offers 5 alcove balconies that hang over the lake



Vintage Room (930 sf)

U-shape	25
Conference	35
Crescent rounds	35
Classroom	32
Banquet w/ dance area	50
Banquet	50
Theater	60

Offering black chandeliers, a marble fireplace, private patio and views of the lake and golf course

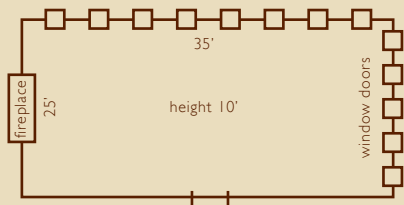

Tasting Room (765 sf)

Conference	20
Crescent rounds	28
Banquet w/ dance area	30
Theater	40

Our newest room offers mountain and vineyard views, state of the art 100 in. flat screen and a private patio

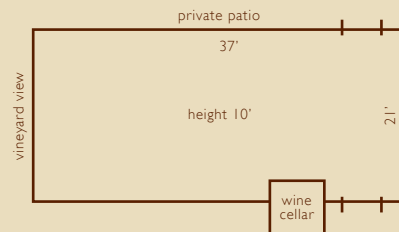

Executive Boardroom (600 sf)

Conference	14
------------	----

Boardroom doors open to a semi-private patio near our waterfall courtyard - adjacent to the lobby

